

8

7

6

5

4

3

2

1

COVER SELECTION					
SELECTION	PART NUMBER	COVER HEIGHT (H)	FITS BOLLARD SIZE (I.D.)	MATERIAL	COVER WEIGHT
	BC4F0630-4	30"	4" NPS (4.5" O.D.)	304 SS	28LBS
	BC4F0636-4	36"			31LBS
	BC4F0640-4	40"			33LBS
	BC4F0642-4	42"			36LBS
	BC6F0630-4	30"		316L SS	28LBS
	BC6F0636-4	36"			32LBS
	BC6F0640-4	40"			34LBS
	BC6F0642-4	42"			36LBS
APPROVAL SIGNATURE:					
DATE:					

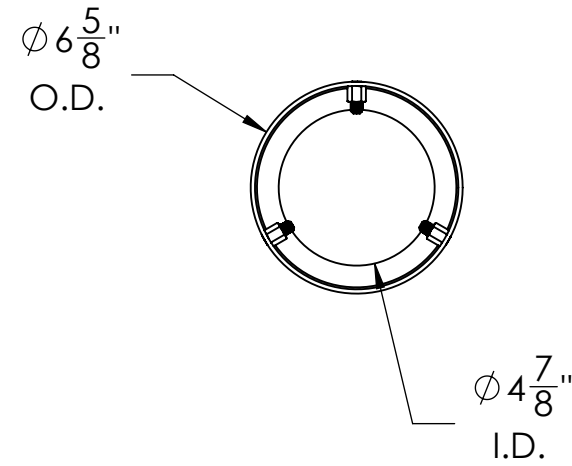

NOTE: BOLLARD SHOULD BE WITHIN 1/4" -1" SHORTER THAN OVERALL HEIGHT OF COVER

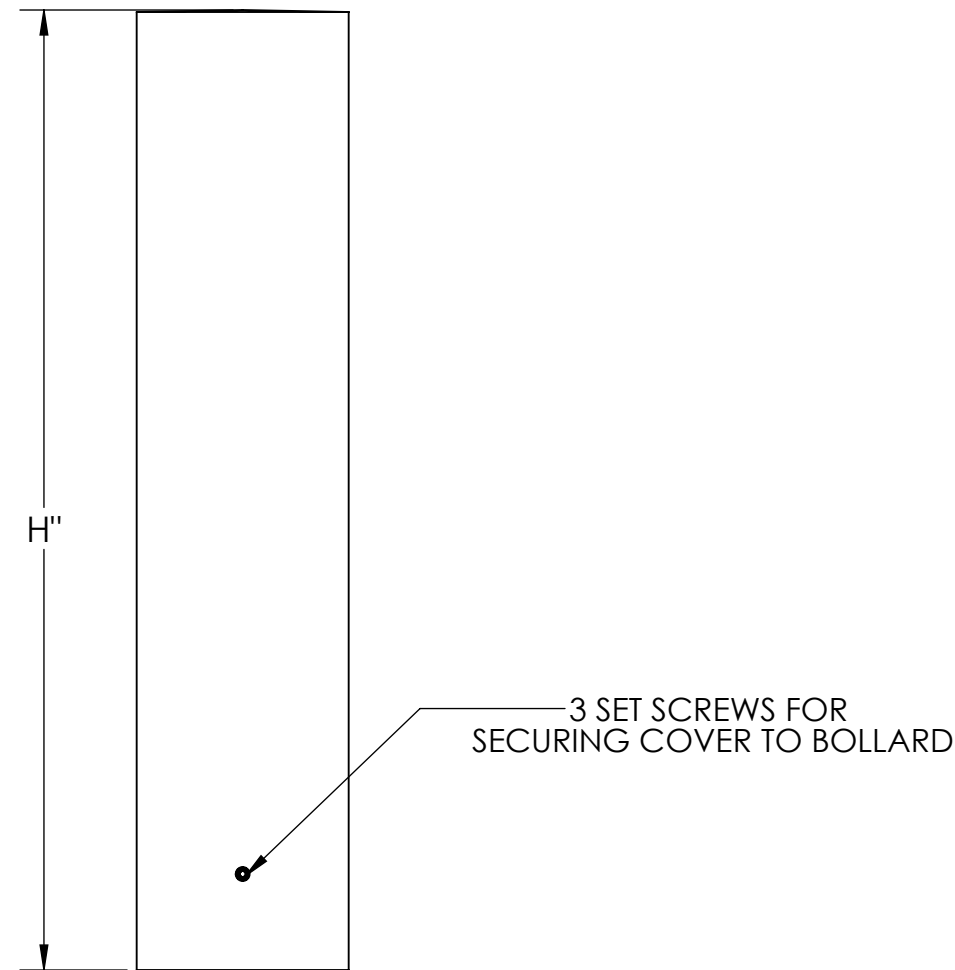

#4 CIRCUMFERENTIAL BRUSHED FINISH



NOTE: OTHER MATERIALS/FINISHES AVAILABLE - CONTACT FOR MORE INFORMATION

NO MANUAL REVISIONS/CHANGES ALLOWED

	NAME	DATE
DRAWN BY	S.J.	9/21/2020
CHECKED BY	J.HU.	9/21/2020

**BARRIER DEFENSE SYSTEMS**  
A SHAW STAINLESS COMPANY  
986 ROSEDALE DR.  
HIRAM, GA 30141  
(678) 915-2080

PROPRIETARY AND CONFIDENTIAL  
THE INFORMATION CONTAINED IN THIS DRAWING IS THE SOLE PROPERTY OF SHAW STAINLESS LLC.  
ANY REPRODUCTION IN PART OR AS A WHOLE WITHOUT THE WRITTEN PERMISSION OF SHAW STAINLESS LLC IS PROHIBITED.

DESCRIPTION:	
6" FLAT TOP BOLLARD COVER	
REV.	ITEM NO:
	SEE SELECTOR

8

7

6

5

4

3

2

1